

ECOPHON SOMBRA™ A

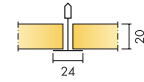

For applications requiring a dark ceiling having low light reflection and good sound absorbing properties. Ecophon Sombra A has an exposed grid system. Each tile is easily demountable. The system consists of Ecophon Sombra A tiles and Ecophon Connect grid systems, with an approximate weight of 3 kg/m² (6 kg/m² with X-bass). The tiles are manufactured from high density glass wool. The visible surface is a matt black batch painted glass tissue and the back of the tile is covered with glass tissue. The edges are natural. For special applications i.e. cinemas, tiles with a sound reflecting surface, Sombra A/gamma, are available. To improve absorption in the low frequency range, Sombra X-bass can be installed on top of the suspended ceiling. For more information see application "Ecophon in Cinemas". For best performance and system quality, use Ecophon Connect grid and accessories. The grid is manufactured from galvanized steel.

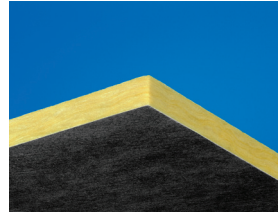

Sombra A tile

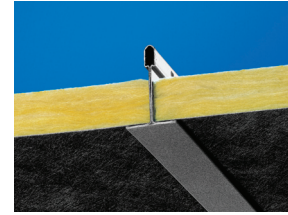

Section of Sombra A system

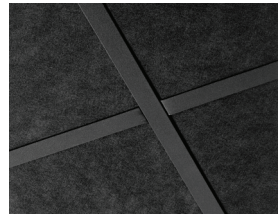

Sombra A system

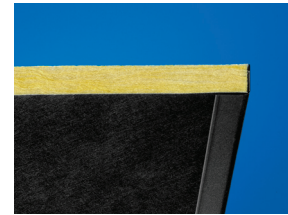

Sombra E with Connect Angle trim black

SYSTEM RANGE

Size, mm	600	1200
	x	x
	600	600
T24	•	•
Thickness	20	20
Inst. Diagr.	M74	M74

TECHNICAL PROPERTIES

ACOUSTIC Sound Absorption Test results according to EN ISO 354. Classification according to EN ISO 11654, and the single value ratings for NRC and SAA according to ASTM C 423.

α_p Practical sound absorption coefficient

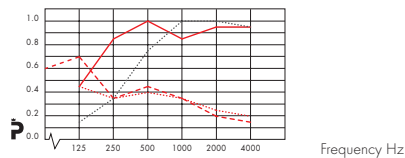

— Ecophon Sombra A 200 mm o.d.s.
 Ecophon Sombra A/gamma 200 mm o.d.s.
 - - - Ecophon Sombra A/gamma + Sombra X-bass 200 mm o.d.s.
 ... Ecophon Sombra A 50 mm o.d.s.
 o.d.s = overall depth of system

Product	Sombra A	Sombra A/gamma	Sombra A/gamma + X-bass
o.d.s mm	50	200	50
absorption class	D	A	E
NRC			
SAA			
α_w			

Sound Insulation Not applicable.

Sound Privacy Not applicable

ACCESSIBILITY The tiles are easily demountable. Minimum demounting depth according to installation diagrams.

CLEANABILITY Weekly dusting and vacuum cleaning.

VISUAL APPEARANCE Black 997, nearest NCS colour sample S 9000-N, 3-4% light reflectance.

INFLUENCE OF CLIMATE The tiles withstand a permanent ambient RH up to 95% at 30°C without sagging, warping or delaminating (ISO 4611).

INDOOR CLIMATE Certified by the Indoor Climate Labelling and recommended by the Swedish Asthma and Allergy Association.

ENVIRONMENTAL INFLUENCE Granted the Nordic Swan eco-label. Fully recyclable.

FIRE SAFETY The glass wool core of the tiles is tested and classified as non-combustible according to prEN ISO 1182. The systems are classified as fire protective covering according to NT FIRE 003. See Technical properties, Fire safety.

Reaction-to-fire classification

Country	Standard	Class
Europe	EN 13501-1	A2s1,d0

MECHANICAL PROPERTIES For information regarding live load and requirements for load bearing capacity, see installation diagrams. Conditions: See Functional demands, Mechanical properties.

INSTALLATION Installed according to system range. (The tiles have to be installed according to the arrows on the back of the tile.)

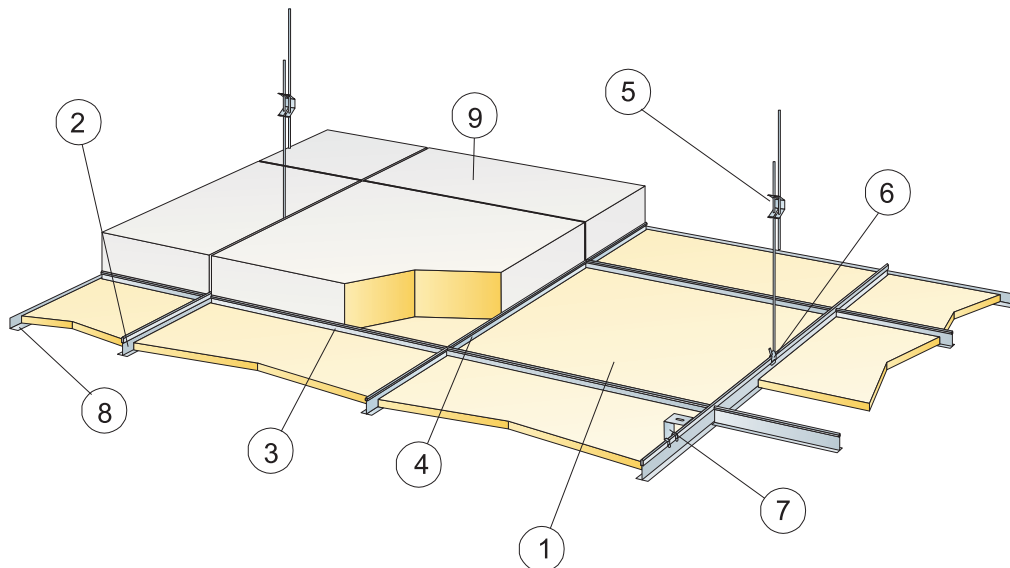

© Ecophon Group

QUANTITY SPECIFICATION (EXCL. WASTAGE)

		Size, mm	
		600x600	1200x600
1	Sombra A	2,8/m ²	1,4/m ²
2	Connect T24 Main runner black, installed at 1200 mm centres	0,9m/m ²	0,9m/m ²
3	Connect T24 Cross tee black, L=1200 mm, installed at 600 mm centres	1,7m/m ²	1,7m/m ²
4	Connect T24 Cross tee black, L=600 mm	0,9m/m ²	-
5	Connect T24 Cross tee, L=1200 mm, installed at 600 mm centres	0,7/m ²	0,7/m ²
6	Connect Hanger clip	0,7/m ²	0,7/m ²
7	For direct installation without x-bass: Connect Direct bracket, installed at 1200 mm centres	0,7/m ²	0,7/m ²
8	Connect Angle trim black, (fixed at 300 mm centres)	as required	as required
9	Sombra X-bass 596x595x90 mm (if required)	as required	as required
Δ Min. overall depth of system: Sombra A: 50 mm (Direct bracket). Sombra A/with x-bass: 150 mm.		-	-
δ Min. demounting depth: Sombra A: 130 mm, Sombra A/with x-bass: 400 mm		-	-

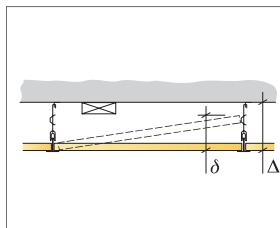

See Quantity specification

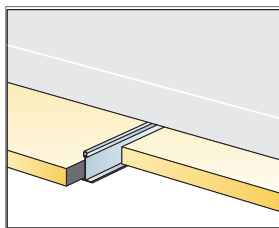

Installation with Sombra X-bass

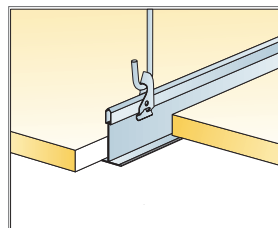

Suspension with adjustable hanger and clip

Size, mm	Max live load [N]	Min load bearing capacity [N]
600x600	50	160
1200x600	50	160

Live load/load bearing capacity